

Walther Engineering and Manufacturing Co., Inc.

Application Guide for 161 Hub Fill Plug - Non Magnetic

Easy-Roll Hubs™ for P Straight-Spindle Axles with Fill Plug					Easy-Roll Hubs™ for P Straight-Spindle Axles with 16.5 x 7" Cast Drum with Fill Plug				
Part Number	Application	Standout Lbs.		Bolts	Part Number	Application	Standout Lbs.		Bolts
10-00161F-001	Hub Piloted/Aluminum Dual Wheel	3.96"		47 02-00045	1003161F-031043*	Hub/Cast Drum Assy,HP,AL Whl	3.54"	156	02-00045
10-00161F-002	Hub Piloted/Steel Dual Wheel	3.03"		45 02-00044	1003161F-032043*	Hub/Cast Drum Assy,HP,ST Whl	2.61"	155	02-00044
10-00161F-101	ABS Hub Piloted/Aluminum Dual Wheel	3.96"		47 02-00045	1003161F-131043*	ABS Hub/Cast Drum Assy,HP,AL Whl	3.54"	157	02-00045
10-00161F-102	ABS Hub Piloted/Steel Dual Wheel	3.03"		46 02-00044	1003161F-132043*	ABS Hub/Cast Drum Assy,HP,ST Whl	2.61"	155	02-00044

Part Number	Application for Stud Piloted	Standout Lbs.	Bolts	Part Number	Application for Stud Piloted Centrifuse® Drum
	Contact us at waltheremc.com				Contact us at waltheremc.com

P Bearings		
HM518410	bearing cup - outer bore	
HM518410	bearing cup - inner bore	
HM518445	bearing cone	

Drums		
03-00043	16.5 x 7" Cast Brake Drum	108 lbs
89996B	16.5 x 7" Centrifuse® Brake Drum	90 lbs
13-00060	16.5 x 8.62" Balanced Brake Drum	122 lbs

Component Parts		
02-39702	Metform - Two-piece, Flanged Wheel Nut,M22x1.5	.4 lbs
05-00046	Tone Ring - 100 Teeth, 6.77 Dia. Pitch Circle	.9 lbs
02-00196	9/16-18 Fill Plug - Non Magnetic	Torque 16-19 LB-FT

Hub Dynamic Load Ratings	
Single Wheel Offset	Load/Hub
0	12,500 lbs
0.56"	12,043 lbs
2.00"	11,000 lbs
2.38"	10,765 lbs
2.75"	10,538 lbs
3.50"	10,105 lbs
3.88"	9,899 lbs
6.66"	7,300 lbs

Estimated Lubricant Fill Volumes**	
30.8 fl-oz	Oil Lubrication Fill Level
129.3 in³	Vol. Between Cup Seats Including Spindle Displacement
35.8 fl-oz	50% Fill Level for Semi-Fluid, Including Spindle Displacement

Centrifuse® is a registered trademark for Motor Wheel® a Hendrickson brand

* Includes two flanged wheel nuts

Walther Engineering and Manufacturing Co., Inc.

Application Guide for 161 Hub with Fill Port and Non-Magnetic Plug

Easy Roll™ Hubs for P Straight-Spindle Axles with 16.5 x 8.62" Cast Brake Drum with Non-Magnetic Fill Plug

Part Number	Application	Standout	Lbs.	Bolts
1003161F-021060*	Hub/Bal Drum Assy,HP,AL Whl	3.46"	169	02-00045
1003161F-022060*	Hub/Bal Drum Assy,HP,ST Whl	2.53"	167	02-00044
1003161F-121060* ABS	Hub/Bal Drum Assy,HP,Al Whl	3.46"	170	02-00045
1003161F-122060* ABS	Hub/Bal Drum Assy,HP,St Whl	2.53"	168	02-00044

Part Number	Application for Stud Piloted Centrifuse® Drum	Standout	Lbs.	Bolts
-------------	---	----------	------	-------

Contact us at waltheremc.com

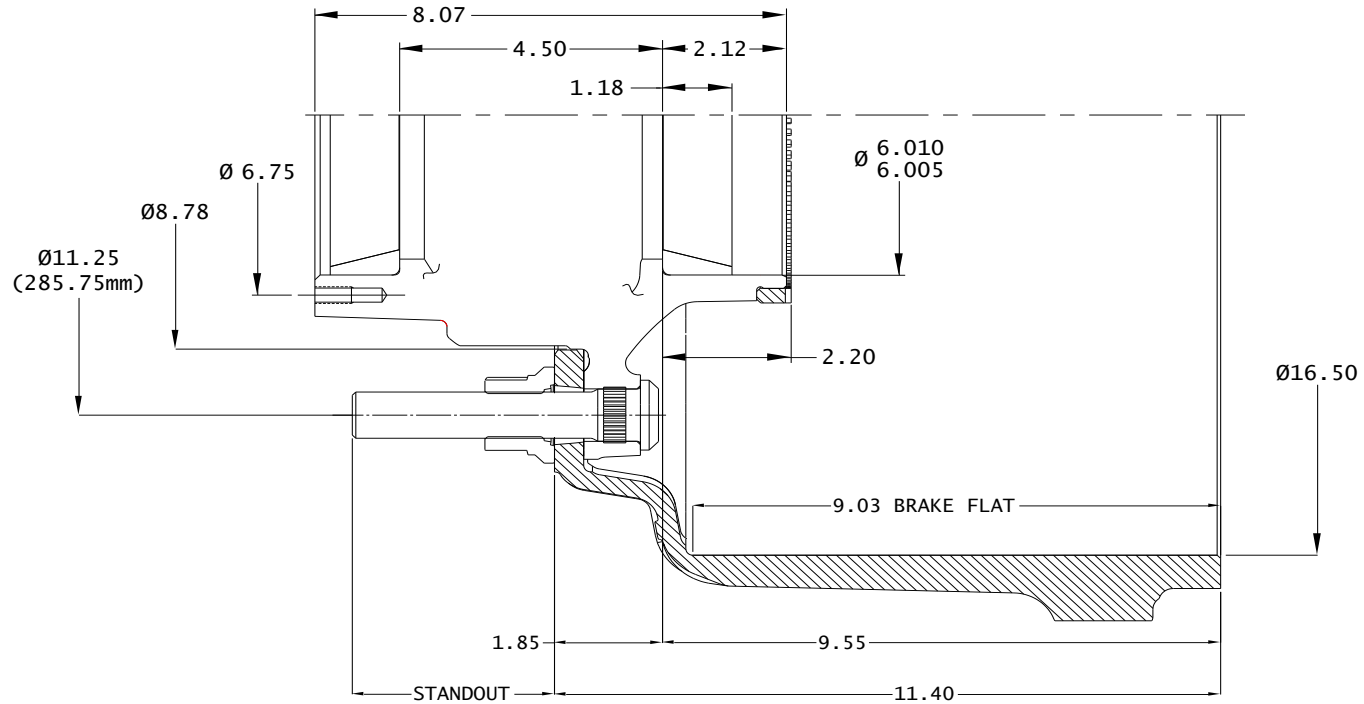

* Includes two flanged wheel nuts