

Walther Engineering and Manufacturing Co., Inc.
Application Guide for 106 Hub with Fill Port and Magnetic Plug

Easy-Roll™ Hubs for N Tapered-Spindle Axles with Fill Plug				
Part Number	Application For Hub Piloted	Standout Lbs.	Bolts	
10-00106M-001	Hub Piloted/Aluminum Dual Wheel	3.96"	44	02-00045
10-00106M-002	Hub Piloted/Steel Dual Wheel	3.03"	42	02-00044
10-00106M-101	ABS Hub Piloted/Aluminum Dual Wheel	3.96"	45	02-00045
10-00106M-102	ABS Hub Piloted/Steel Dual Wheel	3.03"	42	02-00044

Part Number	Application For Stud Piloted	Standout Lbs.	Bolts	
Contact us at waltheremc.com				

N Bearings				
HM212011	bearing cup - outer bore			
HM218210	bearing cup - inner bore			
HM212049	bearing cone - outer bore			
HM218248	bearing cone - inner bore			

Drums				
03-00043	16.5 x 7" Cast Brake Drum	108 lbs		
13-00095	16.5 x 7" Centrifuse® Brake Drum (89996E)	90 lbs		
13-00060	16.5 X 8.62 Balanced Drum	122 lbs		See Page 2

Component Parts				
WN333T	Two-piece, Flanged Wheel Nut, M22x1.5	.4 lbs		
05-00046	Tone Ring- 100 Teeth, 6.77 Dia Pitch Circle	.9 lbs.		
02-00166	9/16-18 Fill Plug - Magnetic	Torque 16-19 LB-FT		

Hub Dynamic Load Ratings		
Single Wheel Offset	Load/Hub	
0	11,250 lbs	
0.56"	10,839 lbs	
2.00"	10,000 lbs	
2.38"	9,689 lbs	
2.75"	9,484 lbs	
3.50"	9,095 lbs	
3.88"	8,910 lbs	
6.66"	Prohibited- See 042 Hub	

Estimated Lubricant Fill Volumes**	
20.88 fl-oz	Oil Lubrication Fill Level
94.65 in ³	Vol. Between Cup Seats Including Spindle Displacement
26.22 fl-oz	50% Fill Level for Semi-Fluid, Including Spindle Displacement

** Actual lubricant volume should be adjusted for specific components used. See TMC RP 631B

Easy-Roll™ Hubs for N Tapered-Spindle Axles with 16.5 x 7" Cast Drum with Fill Plug				
Part Number	Application For Hub Piloted	Standout Lbs.	Bolts	
1003106M-031043*	Hub/Cast Drum Assy, HP, AL Whl	3.54"	153	02-00045
1003106M-032043*	Hub/Cast Drum Assy, HP, ST Whl	2.61"	151	02-00044
1003106M-131043*	ABS Hub/Cast Drum Assy, HP, AL Whl	3.54"	154	02-00045
1003106M-132043*	ABS Hub/Cast Drum Assy, HP, ST Whl	2.61"	152	02-00044

Part Number	Application For Stud Piloted	Standout Lbs.	Bolts	
Contact us at waltheremc.com				

Easy-Roll™ Hubs for N Tapered-Spindle Axles with 16.5 x 7" Centrifuse® with Fill Plug				
Part Number	Application For Hub Piloted	Standout Lbs.	Bolts	
1003106M-041095*	Hub/Fused Drum Assy, HP, AL Whl	3.71"	135	02-00045
1003106M-042095*	Hub/Fused Drum Assy, HP, ST Whl	2.78"	133	02-00044
1003106M-141095*	ABS Hub/Fused Drum Assy, HP, AL Whl	3.71"	136	02-00045
1003106M-142095*	ABS Hub/Fused Drum Assy, HP, ST Whl	2.78"	134	02-00044

Part Number	Application For Stud Piloted	Standout Lbs.	Bolts	
Contact us at waltheremc.com				

* Includes two flanged wheel nuts; # Includes ten flanged wheel nuts

Walther Engineering and Manufacturing Co., Inc.

Application Guide for 106 Hub with Fill Port and Magnetic Plug

Easy Roll™ Hubs for N Tapered-Spindle Axles with 16.5 x 8.62" Cast Brake Drum with Fill Plug

Part Number	Application For Hub Piloted	Standout	Lbs.	Bolts
1003106M-021060*	Hub/Bal Drum Assy,HP,AL Whl	3.46"	166	02-00045
1003106M-022060*	Hub/Bal Drum Assy,HP,ST Whl	2.53"	164	02-00044
1003106M-121060* ABS	Hub/Bal Drum Assy,HP,AI Whl	3.46"	167	02-00045
1003106M-122060* ABS	Hub/Bal Drum Assy,HP,St Whl	2.53"	164	02-00044

Part Number	Application For Stud Piloted	Standout	Lbs.	Bolts
-------------	------------------------------	----------	------	-------

Contact us at waltheremc.com

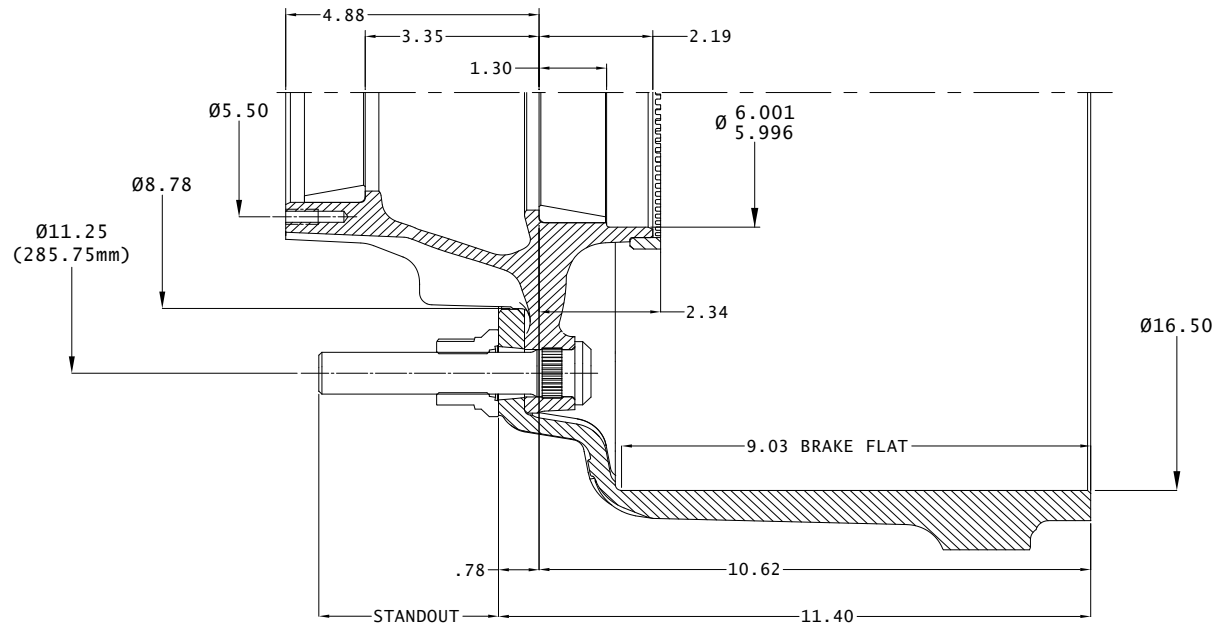

* Includes two flanged wheel nuts